



Broan and S&P

Residential Balanced Ventilation Systems

Residential balanced ventilation systems introduce fresh air alone, or include Heat Recovery (HRV) or Energy Recovery (ERV) features. Select the unit that best matches the square footage requirements of your home or small office.

Code #	Description	Model
--------	-------------	-------



AE60

Air Exchanger

Fresh air systems draw outside air in and expel stale indoor air. These units may be installed wherever it is convenient, or where ducting to individual rooms is simplified.

- 160–185 CFM
- Typically recommended for mild climates
- Flexible installation options—install mounted or suspended from chains

Wall control included with 3 modes: Normal, Boost & Recirculation

476-4025	Fresh Air Introduction up to 2,500 sq. ft.	AE60
----------	--	------



ERV90HC

Heat or Energy Recovery up to 3,500 sq. ft.*

For average-size homes, these models are available with either Heat or Energy Recovery options.

- Up to 96 CFM
- Available with side or top ports
- Flexible installation options—install mounted or suspended from chains

Control Option: VT4W wall control (Min/Max/Intermittent: 20-Min, On/40-Min. Off)

476-4005	Heat Recovery up to 3,500 sq. ft. - Side Port	HRV90HS
476-4021	Heat Recovery up to 3,500 sq. ft. - Top Port	HRV90HT



HRV100H

Heat or Energy Recovery up to 7,500 sq. ft.*

For larger homes and small offices, these models are available with either Heat or Energy Recovery options.

- Up to 235 CFM
- Flexible installation options—install mounted or suspended from chains

Control Option: VT1W (Central Wall), VB20W (20-Min Timer), DH100W (Remote Dehumidistat), 59W (60-Min Timer), VT2W (electro wall control)

476-4030	Heat Recovery for homes up to 4,500 sq. ft.	HRV100H
476-4035	Heat Recovery for homes up to 7,500 sq. ft.	HRV200H
476-4040	Energy Recovery for homes up to 4,500 sq. ft.	ERV100HC

Model	AE60	HRV90H	HRV100H	HRV200H	ERV90HC	ERV100HC
sq. ft.	2,500	3,500	4,500	7,500	3,500	4,500
Length	23	12.81	21.1	21.1	12.8	21.1
Width	12.25	22.56	34.6	34.6	22.56	34.6
Height	15	19.81	13.25	13.25	19.81	13.25
CFM	160–185	45–96	64–146	108–235	45–99	60–142
Volts/Watts	120/140	120/150	120/147	120/202	120/150	120/150
Amps	1.2	1.3	1.4	1.9	1.3	1.4
	N/A	34	28.005	24.5	500-750	120/456
Weight	40	39	65	73	45	65
Fresh Air	•	•	•	•	•	•
Heat Recovery		•	•	•		
Energy Recovery					•	•



GSHH3K

HEPA Filtration plus Balanced Ventilation Systems

HEPA Filtration plus Balanced Ventilation Systems provide year-round air filtration, plus energy saving features matched to any climate. HEPA (High Efficiency Particulate Air) with antimicrobial protection is the most effective filtration available, capturing 99.97% of airborne particles including dust, allergens and pet dander.

Code #	Description	Model
--------	-------------	-------

HEPA Filtration Fresh Air Ventilation - Model GSVH1K

Model GSVH1K brings fresh air in and continually filters air throughout the home. This model is best suited in mild climates.

- 270/165 CFM
- Homes up to 6,000 sq. ft.

476-3105	HEPA Filtration Fresh Air Ventilation with Wall Control	GSVH1K
----------	---	--------

HEPA Filtration & Heat Recovery - Model GSHH3K

Model GSHH3K tempers incoming fresh air with outgoing stale air to minimize energy expenditures. The closed system transfers the heat without contaminating the fresh air. This model is best suited for cooler climates.

- 270/165 CFM
- Electronic wall control
- Homes up to 6,000 sq. ft.

The electronic wall control for the GSHH3K provides superior functionality in manual and programmable modes. The stylish, backlit LCD displays mode, outdoor temperature, pre-filter, HEPA and core filter maintenance requirements, and provides four operating modes using simple buttons and icons.

Control Option: Wall control included with 3 modes: Normal, Boost & Recirculation

476-3100	HEPA Filtration & Heat Recovery with Wall Control	GSHH3K
----------	---	--------

Model	GSHH3K	GSVH1K	GSFH1K
sq. ft.	6000	6000	6000
Length	29.4	29.4	29.4
Width	22.9	22.9	22.9
Height	17.8	17.8	17.8
CFM	270/165	270/165	270/165
Volts/Watts	120/152	120/220	120/180
Amps	2	1.9	1.5
Weight	42	42	35
Fresh Air	•	•	
Heat Recovery	•		
Energy Recovery			
HEPA Filtration	•	•	•



Broan Indoor Air Quality Accessories

Code #	Description	Model
--------	-------------	-------



DH100W

Dehumidistat

- White Finish
- Dual voltage (24V/120V).
- Variable setting from 20-80% relative humidity.

476-4020	Dehumidistat	DH100W
----------	--------------	--------



VB20W

20-Minute Push Button Timer

- Off-Low-High Speed-Intermittent 20 min./hour
- Dehumidistat
- Low voltage

476-4075	20-Minute Push Button Timer	VB20W
----------	-----------------------------	-------



VT1W

Basic Wall Control

- Off-Low-High rocker switch
- Dehumidistat
- Low voltage

476-4050	Basic Wall Control	VT1W
----------	--------------------	------



VT2W

Electro Wall Control

- Intermittent-Low-High psuh-button switch
- Dehumidistat
- Low voltage

476-4060	Electro Wall Control	VT2W
----------	----------------------	------

Broan Indoor Air Quality Accessories

476-4010	Wall Control, Off/Low/High Speed/Intermittent 20 min./hour	VT4W
----------	--	------



Broan Caps

Code #	Description	Model
--------	-------------	-------



634

Black Roof Cap

- Built-in backdraft damper and bird screen.
- Steel housing, black electrically bonded epoxy finish.

476-2000	For 3 1/4" x 10" or up to 8" round duct	634
----------	---	-----



636

Black Roof Cap

- For 3" or 4" round duct
- Built-in backdraft damper and bird screen
- Steel baked black enamel finish

476-2100	Black Roof Cap - For 3" or 4" round duct	636
----------	--	-----



639

Black Wall Cap

- For 3 1/4" x 10" duct
- Spring-loaded backdraft damper
- Built-in bird screen
- Steel baked black enamel finish
- 24 GA CRCQ Steel, black electrically-bonded epoxy finish

476-2200	Black Roof Cap - For 3 1/4" x 10" duct	639
----------	--	-----



641

Aluminum Wall Cap

- For 6" round duct
- Built-in backdraft damper and bird screen
- Aluminum natural finish

476-2400	Aluminum Roof Cap	641
----------	-------------------	-----



885BL

Black Wall Cap

- For 3" or 4" round duct
- 4" to 3" transition included
- Standard package - 6 to a carton
- Built-in bird screen
- 24 GA CRCQ Steel, black electrically-bonded epoxy finish
- Built-in damper
- *Not intended for Dryer Vent usage*

476-2350	Black Roof Cap - For 3" or 4" Round Duct	885BL
----------	--	-------

Installation Kit

- Tandem Y
- Complete Exterior Vent
- Screws

476-4015	Installation Kit	TYIK1
----------	------------------	-------



BROAN



676



671



678



655

Broan Ventilation Fans

Code #	Description	Model
--------	-------------	-------

Ceiling Mount Ventilation Fan

- 80 to 110 CFM; 2.5 to 4 Sones
- Centrifugal blower wheel and 4-pole motor deliver high exhaust capacity at low sound levels
- White polymeric grille complements virtually any decor
- Torsion spring grille mounting—no tools necessary

476-0695	110 CFM - 4.0 Sones	676
----------	---------------------	-----

Ceiling/Wall Mount Ventilation Fan

- 50 to 70 CFM; 4 to 6 Sones
- Powerful centrifugal blower wheel
- Compact housing fits between ceiling joists or wall studs
- Double-strength steel mounting flanges with keyhole slots for fast installation

476-0690	70 CFM - 6.0 Sones	671
476-0800	50 CFM - 4.0 Sones	688

Ventilation Fan with Light

- 50 CFM; 2.5 Sones
- Bright 100-watt lighting capacity. *Bulb not included*
- Shatter-resistant light diffusing lens
- Type IC (Insulation Contact)

Quality Broan features and easy installation make this an extremely popular series.

- Designer styled white polymeric grille complements virtually any decor
- Plug-in, permanently lubricated motor
- Efficient polymeric fan impeller
- Mounting ears offer quick, sturdy installation
- UL listed for use over bathtubs and showers when connected to a GFCI-protected branch circuit
- Polymeric duct connectors with tapered sleeves for easy, positive ducting

476-0700	Ventilation Fan with Light; 50 CFM 2.5 Sones	678
----------	--	-----

Ventilation Fan with Light and Heater

- 70 CFM; 4.0 Sones
- Designer styled white polymeric grille complements virtually any decor
- Fan and heater function independently or together
- Bright 100-watt light capacity. *Bulb not included*
- 20-amp circuit required
- Type IC (Insulation Contact)

All in one compact, easy-to-install unit.

- Two blower wheels, each powered by its own permanently lubricated plug-in motor, quietly deliver high-efficiency performance
- 1300-watt heater for fast, even heat distribution
- Built-in damper prevents backdrafts and eliminates metallic clatter
- Adjustable, slotted mounting brackets span up to 24" for easy installation
- Polymeric 4" round duct features a 2" long tapered sleeve for easy, positive ducting

476-0600	Ventilation Fan with Light and Heater; 70 CFM 4 Sones	655
----------	---	-----



Broan Ultra Silent Bathroom Fans

Code #	Description	Model
--------	-------------	-------



QTXE110S

Ultra Silent Humidity Sensing Fan

- 0.7 Sones
- 110 CFM
- Sensaire® technology detects the rapid rise in humidity over time
- Auto shut-off time is adjustable from 5 to 60 minutes
- Helps prevent lingering, excessive humidity which can cause mold
- Humidity is sensed at the ceiling where it is most prevalent
- Hanger bars for Easy, Fast and Universal installation in all types of construction
- UL Listed for use over bathtubs and showers when connected to a GFCI protected branch circuit
- 6" ducting for superior performance
- ENERGY STAR® qualified

Control Option: Wired 24/7

Fan Model	CFM	Sones	Energy Star	Bath Sq. Ft.	Ducting
QTXE110S	110	0.7	Yes	100	6" +

476-0125	110 CFM - 0.7 Sones	QTXE110S
----------	---------------------	----------



QTXE050

Ultra Silent Bath Fan

- Energy Star qualified
- Motor engineered for continuous operation
- UL Listed for use over tub/shower with GFCI circuit
- Hanger bars for Easy, Fast and Universal installation in all types of construction
- Housing Dimension: 10-1/2" x 11-3/8" x 7-5/8" - Fits 2" x 8" construction
- Grille Dimension: 13" x 14"

Fan Model	CFM	Sones	Energy Star	Bath Sq. Ft.	Ducting
QTXE050	50	<0.3	Yes	45	6" +
QTXE080	80	0.3	Yes	75	6" +

476-0110	50 CFM - <0.3 Sones	QTXE050
476-0115	80 CFM - 0.3 Sones	QTXE080



QTRE110

Ultra Silent Bath Fan

- Nearly silent operation 1.3 Sones
- 110 CFM
- 4" ducting
- ENERGY STAR® qualified
- Motor engineered for continuous operation
- UL Listed for use over tub/shower with GFCI circuit
- Hanger bars for Easy, Fast and Universal installation in all types of construction
- Housing Dimension: 10-1/2" x 11-3/8" x 7-5/8" - Fits 2" x 8" construction
- Grille Dimension: 13" x 14"

Fan Model	CFM	Sones	Energy Star	Bath Sq. Ft.	Ducting
QTRE110	110	1.3	Yes	100	4"

476-0130	110 CFM - 1.3 Sones	QTRE110
----------	---------------------	---------



QTXE080FLT



1667H



ACCGSFHP2



D04-021

Code #	Description	Model
--------	-------------	-------

Ultra Silent Bathroom Fan with Lights

- Nearly silent operation 0.3 Sones
- 80 CFM
- 6" ducting for superior performance
- Bright 42W fluorescent lighting – bulb included
- 4W nightlight *Bulb not included*
- Motor engineered for continuous operation
- UL Listed for use over tub/shower with GFCI circuit
- Hanger bars for Easy, Fast and Universal installation in all types of construction
- ENERGY STAR® qualified
- Housing Dimension: 10-1/2" x 11-3/8" x 7-5/8"- Fits 2" x 8" construction
- Grille Dimension: 13-3/8" x 14-1/4"

Model	CFM	Sones	Light/ nightlight	Energy Star	Title 24	Duct
QTXE080FLT	80	0.3	42W / 4W	Yes	Yes	6" +

476-0120	80 CFM - 0.3 Sones	QTXE080FLT
----------	--------------------	------------

Economy Fan Project Packs

476-0860	6 Pack Motor & Grille	1688F
476-0865	6 Pack 1688-1671 Fan Housing	1667H
476-0870	6 Pack Motor & Grille	1671F

Broan Fresh Air System Accessories

476-4089	Annual maintenance filter kit (two pre-filers and one HEPA filter) for our GSHH3K and GSEH3K units)	ACCGSFHP2
476-4091	Annual maintenance filter kit (two pre-filers) for our GSHH3K and GSEH3K units)	ACCGSFP2

Broan Accessories

476-4078	200 HRV ERV Filter Replacements	V03097
476-4087	Electronics board and cover for HRV100H and HRV200H	V12646

Plastic Adapter

475-6040	Plastic Adapter 3" x 4"	D04-021
----------	-------------------------	---------



MIXVENT Duct Fan



MIXVENT Duct Fan Kit

MIXVENT Duct Fans

MIXVENT Duct Fans

TD-MIXVENT fans are fitted with a direct connection two-speed motor. In addition, all motors are suitable for speed control regulation using electronic or auto-transformer controllers. The TD-fans offer the ideal in-line duct fan solution for a wide range of HVAC ventilation applications.

Code#	Description	Model#
476-6000	4" Inline Duct Fan	TD-100
476-6005	4" Inline Duct FanTurbo	TD-100X
476-6010	6" Inline Duct Fan	TD-150
476-6015	8" Inline Duct Fan	TD-200
476-6020	8" Inline Duct Fan Turbo	TD-200X

TD-MIXVENT Duct Fan Kits

The TD ventilation kits enable the simple and fast installation of a complete ventilation system. The kits include the powerful TD in-line fan providing efficient extraction for bathrooms, toilets, washrooms and any other applications that require the removal of bad odors, stuffy and humid air. In addition to the fan, the kits include an interior round air valve (BOC/BOR-100); exterior mounted grill (GR-100); ten feet of flexible aluminum ducting (GSA-100) and a roll of tough ducting tape to provide the complete hardware required for a given ventilation system.

Code#	Description	Model#
476-6025	4" Inline Duct Fan Kit	KIT-100
476-6030	4" Inline Duct FanTurbo Kit	KIT-100X
476-3035	6" Inline Duct Fan Kit	KIT-150DV

See Page 476-9 for MIXVENT Duct Fans Dimensions & Performance



MIXVENT Duct Fans

Dimensions inches/mm

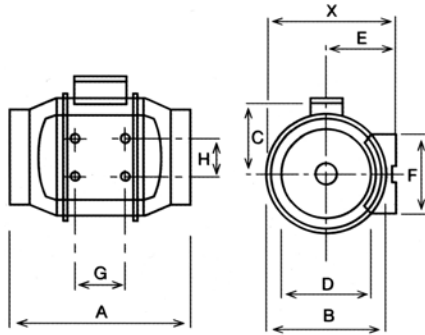

Model	X	A	B	C	D	E	F	G	H
TD-100	5 15/16 151	9 1/8 232	5 7/16 138	3 3/4 96	3 7/8 98	3 1/4 82	3 3/4 95	1 7/8 48	5 3/16 131
TD-100x	7 3/8 188	11 15/16 303	6 15/16 176	4 1/8 115	3 13/16 97	3 15/16 100	3 9/16 90	3 1/8 80	2 1/8 60
TD-125	7 3/8 188	16 7/16 258	6 15/16 176	5 115	4 13/16 123	3 15/16 100	3 9/16 90	3 1/8 80	2 3/8 60
TD-150	8 3/8 212	18 1/4 295	7 7/8 200	5 9/16 127	5 13/16 147	4 3/8 112	5 1/8 130	3 1/8 80	2 1/4 60
TD-200	9 1/8 233	19 11/16 302	8 9/16 217	5 9/16 141	7 13/16 198	4 7/8 124	5 1/2 140	3 15/16 100	3 11/16 94
TD-200x	9 1/8 233	19 11/16 302	8 9/16 217	5 9/16 141	7 13/16 198	4 7/8 124	5 1/2 140	3 15/16 100	3 11/16 94
TD-250	11 7/16 291	25 3/4 386	10 11/16 272	7 9/16 192	9 3/4 248	6 1/8 155	6 5/8 168	5 11/16 145	5 1/2 140
TD-315	14 356	17 3/4 450	13 1/4 336	8 13/16 224	12 1/4 312	7 3/8 188	8 1/4 210	7 3/16 182	7 178

Performance

Model	Nom. RPM	Volts	Max. Watts	Speed	CFM v Static Pressure (SP) Ins. WG								Max. SP	Duct Dia. Ins.
					0"	0.125"	0.25"	0.375"	0.5"	0.75"	1.0"	1.25"		
TD 100	2424	120	23	LS	103	88	61	-	-	-	-	-	.4	4"
	2543	120	26	HS	107	93	69	-	-	-	-	-	.4	4"
TD 100x	1578	120	44	LS	110	87	58	-	-	-	-	-	.375	4"
	2047	120	60	HS	140	120	99	-	-	-	-	-	.55	4"
TD 125	1651	120	44	LS	146	115	73	-	-	-	-	-	.35	5"
	2125	120	59	HS	192	159	128	86	33	-	-	-	.55	5"
TD 150	1924	120	54	LS	239	211	186	160	135	58	-	-	.8	6"
	2444	120	65	HS	312	292	271	249	224	154	60	-	1.15	6"
TD 200	2322	120	139	LS	399	377	356	338	322	288	247	163	1.38	8"
	2781	120	184	HS	479	460	442	425	408	374	341	300	1.625	8"
TD 200x	1935	120	122	LS	392	380	369	352	338	301	211	79	1.4	8"
	2467	120	169	HS	508	496	483	469	454	427	390	332	1.75	8"
TD 250	1870	120	168	LS	543	488	440	389	333	250	208	164	1.85	10"
	2601	120	255	HS	765	729	689	655	621	500	344	275	2.35	10"
TD 315	1875	120	226	LS	793	678	579	464	345	224	167	127	1.5	12.4"
	2563	120	347	HS	1089	1014	939	865	780	616	460	341	2.5	12.4"



LS= Low Speed / HS = High Speed

